



EN

# AINA TALK

## Quick Guide iOS - Version 1.1

THIS GUIDE HELPS  
TO QUICKLY  
UNDERSTAND  
THE SETUP  
OF THE AINA TALK  
APPLICATION.

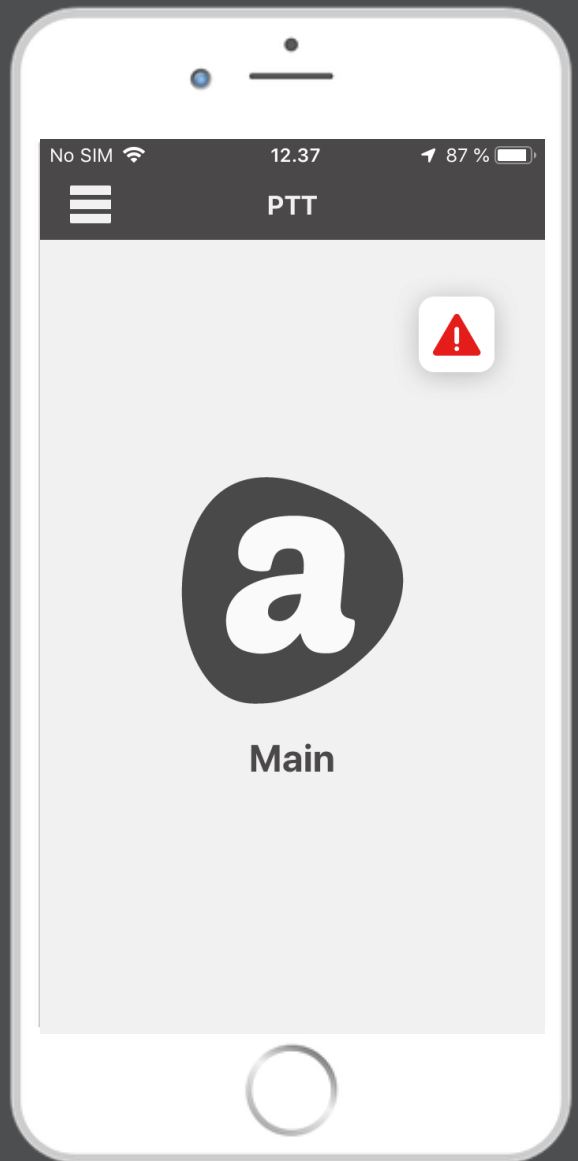

Visit [www.aina-wireless.com](http://www.aina-wireless.com) to find additional solutions and more user guides. If you have any further questions, you can also email us at: [sales@aina-wireless.com](mailto:sales@aina-wireless.com)



# HOW TO INSTALL

1

Scan the QR code or visit the link sent by AINA to download the application

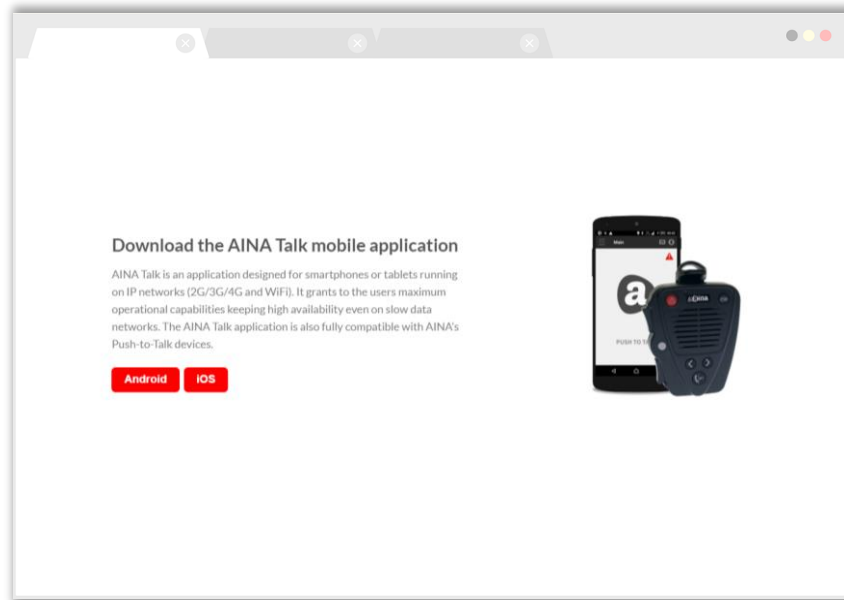

2

Open the AINA Talk application and select the Settings tab

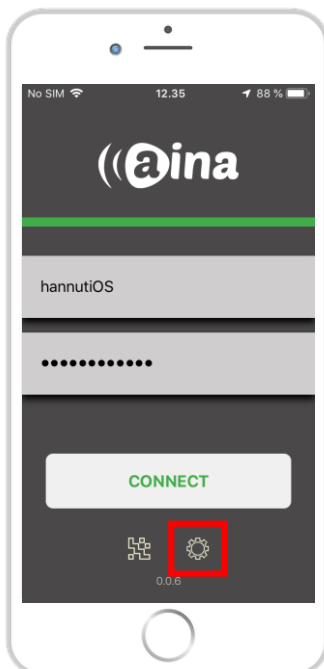

Note! You can alternately use your personal QR code to enter your basic settings automatically. Simply open the QR code scanner, left of the Settings tab.

3

Enter Settings

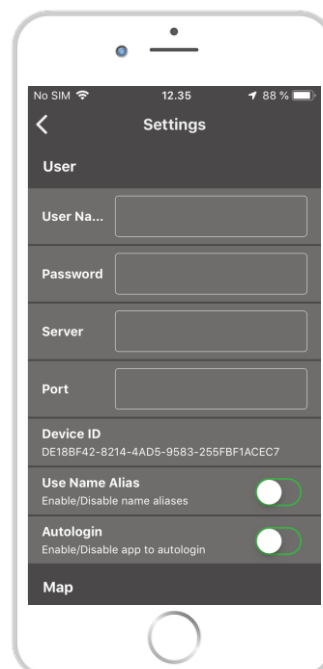

Enter your:

- User Name
- Password
- Server
- Port

And adjust other settings such as: Autologin, Preferred Bluetooth Device, etc.

4

Navigate the app's features by pressing the menu icon and swiping up/down

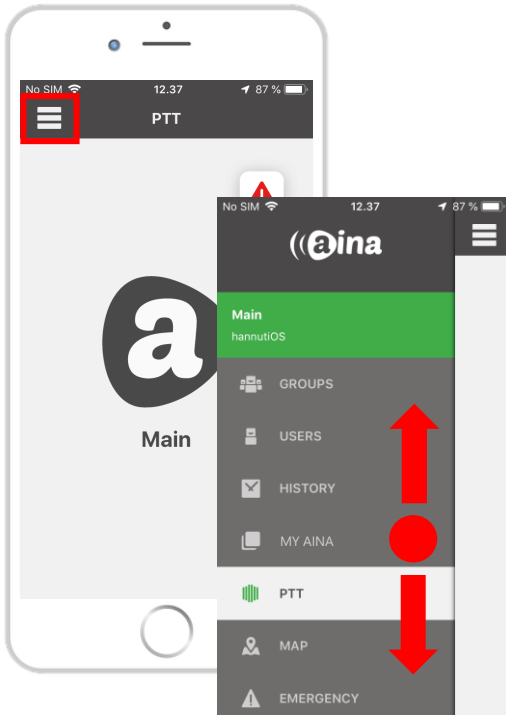

5

Push the AINA push-to-talk button to start communicating

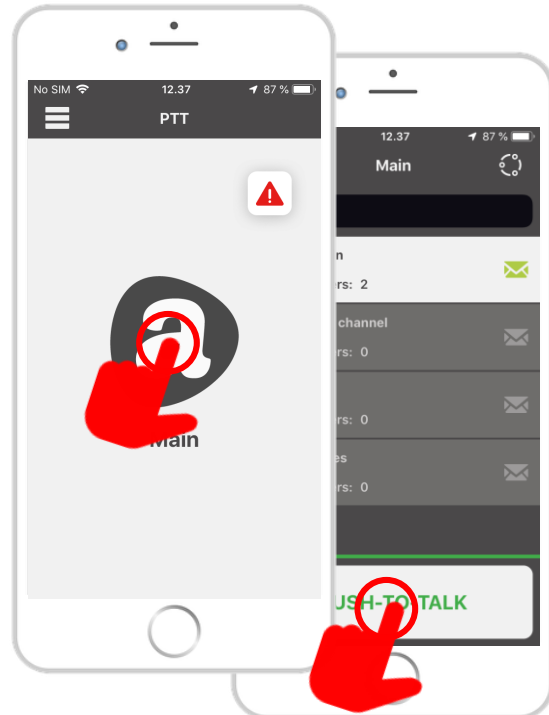

# BASIC FEATURES

1

Group call

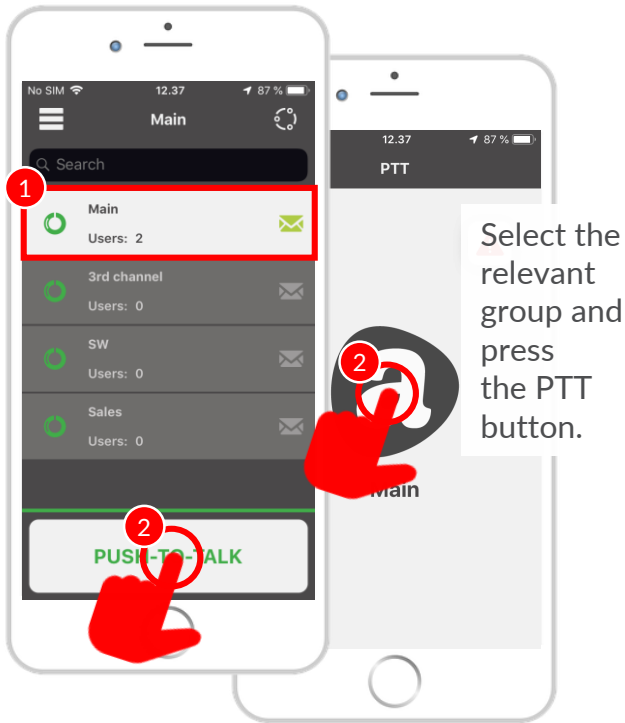

2

Individual call

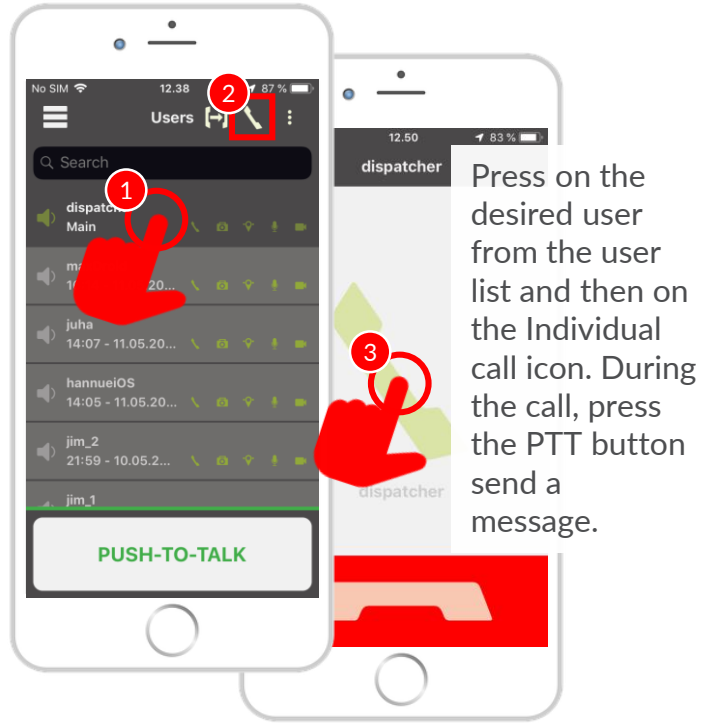

3

Direct call

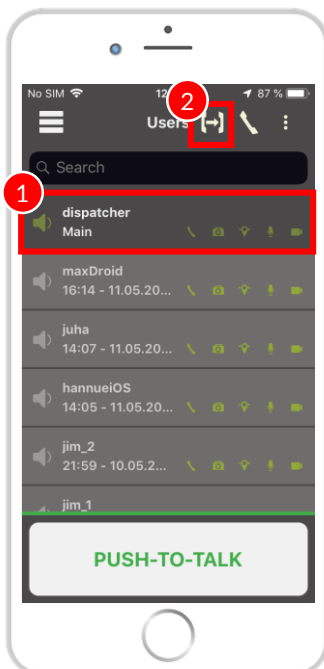

4

Emergency call

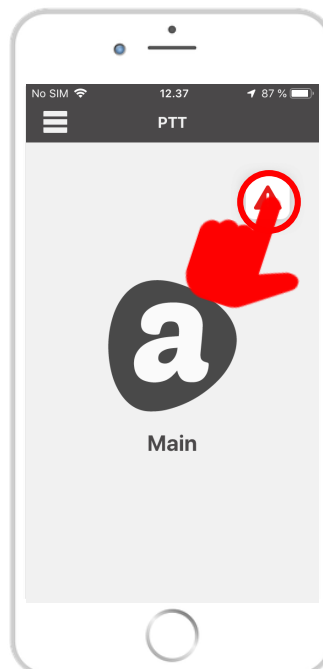

5

### Messaging

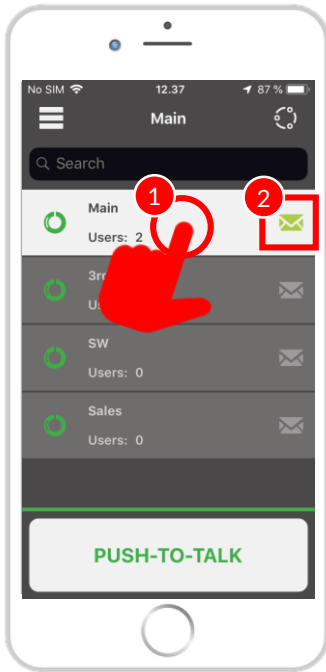

Press the relevant group and then press the Messaging icon.

6

### Map / GPS tracking

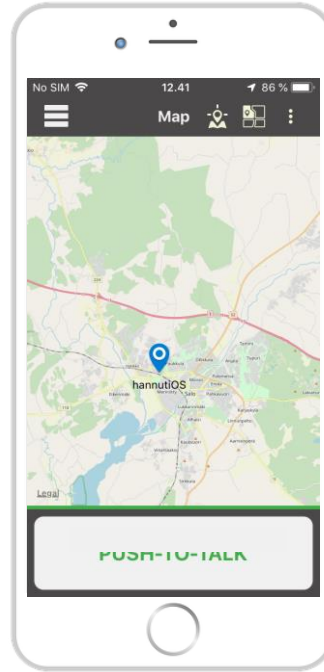

Track your location or a location of the other users on the map. Ensure you have a Smartphone with enabled GPS Location.

7

### Settings

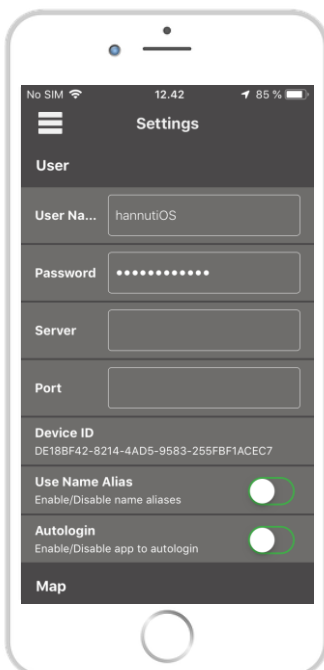

Go to Settings in the navigation menu to change options.

8

### Logout

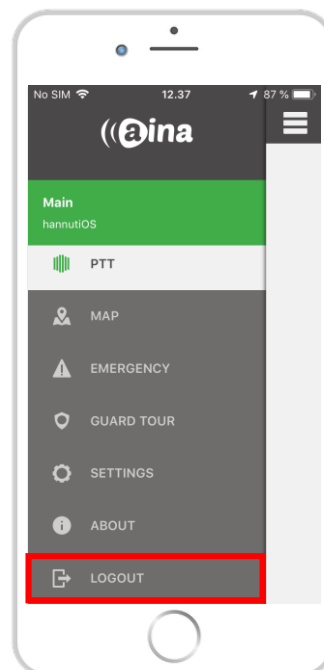

Disconnect the AINA Talk client from the AINA Server by pressing the LOGOUT option in the Navigation menu.