

QUICK GUIDE

Connecting your PTT Voice Responder to Sonim XP5S (Android) (EN)



A

Pair the AINA Accessory to the Sonim XP5S

1. Go to the phone's Settings
2. Select 'Bluetooth'
3. Turn the Bluetooth function on
4. Select your PTT Voice Responder from the list of available devices and wait for it to pair to the phone

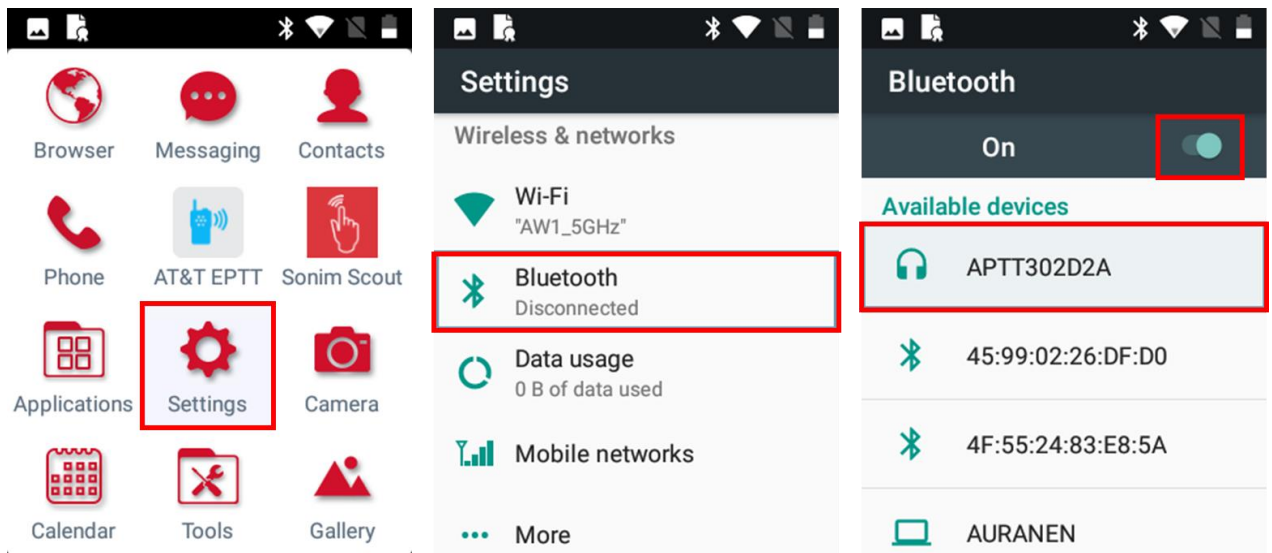

NOTE: The Voice Responder can only be paired with one device at a time. If you want to pair it to another device you need to perform an **Unpairing** by powering the device ON and keeping the power button down for about 10 seconds.



B

Connect the AINA Accessory to the Sonim BLE application

1. Search for and open the 'Sonim Scout' application from your phone
2. Select the 'Utilities' tab
3. Select 'Sonim BLE Connect'
4. Select your PTT Voice Responder from the list
5. Accept the pairing request
6. Wait for the application to show that your accessory is “Connected” and its battery level

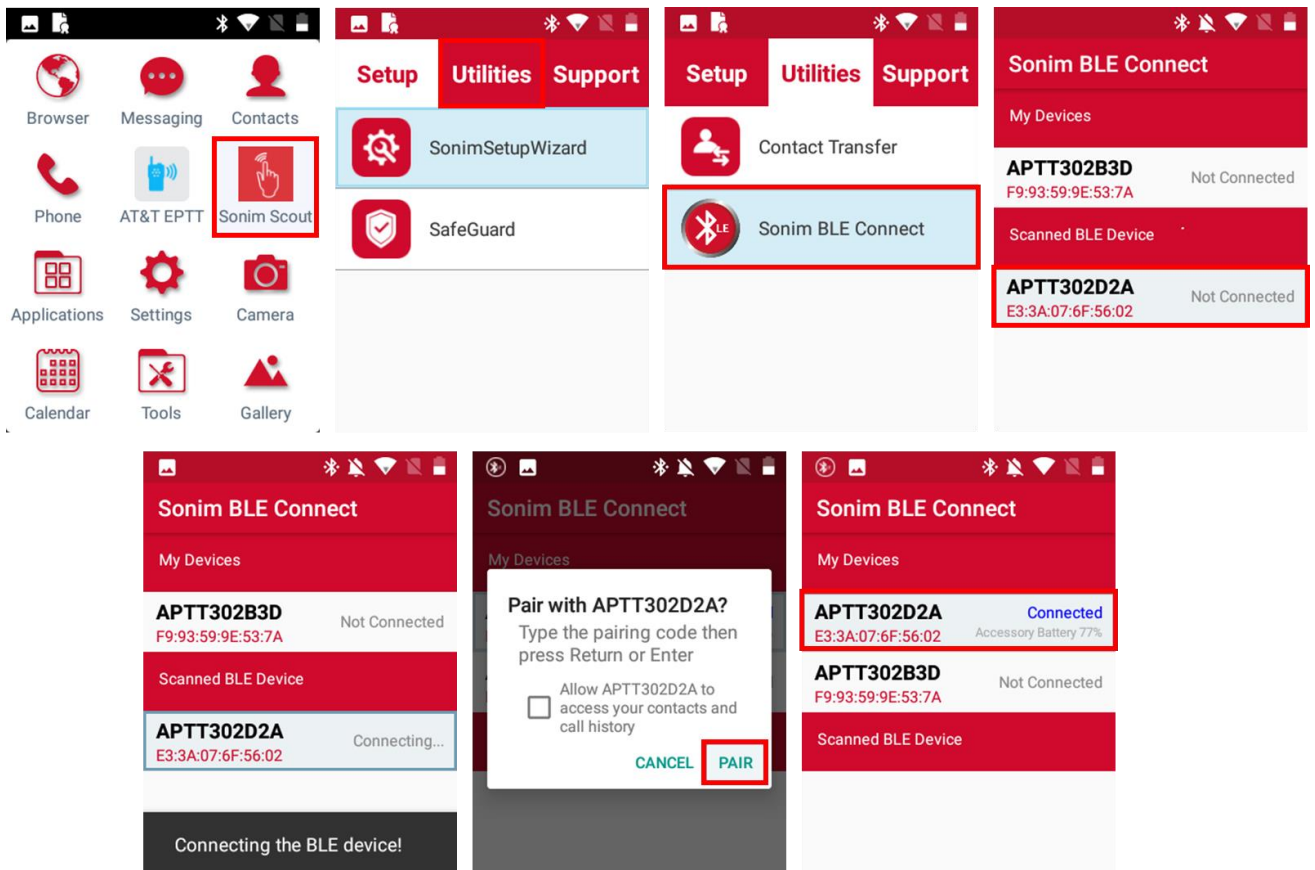

If the app cannot find your PTT Voice Responder, make sure that your Voice Responder is still connected to your phone via Bluetooth (the LED should be blinking in blue). If it is not, perform part A again.

