

# QUICK GUIDE

## Connecting your PTT Voice Responder to Tait PTT (iOS) (EN)



# A

## Pairing your PTT Voice Responder with your iPhone via Bluetooth

1. Turn on your PTT Voice Responder by holding down the Power button for more than 3 seconds. After it is on, a blinking green light will indicate that the device is ready for pairing.
2. Turn on your iPhone's Bluetooth by going to: Settings → Bluetooth → Turn on.
3. Pair your PTT Voice Responder to your iPhone by selecting it from the Devices list. To know which device to select from the list, check the unique friendly name on the back of your Voice Responder. Once it has successfully paired, a blue light will begin blinking on your device.

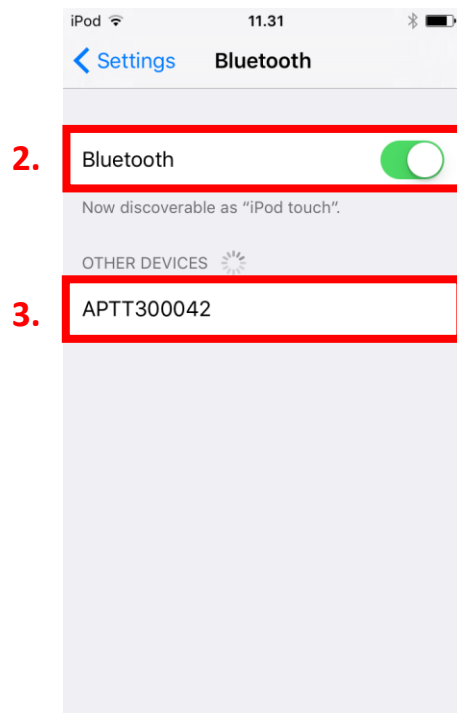

**NOTE:** The Voice Responder can only be paired with one device at a time. If you want to pair it to another device you need to perform an **Unpairing/ Software reset** by pressing and holding both arrow buttons and both PTT buttons simultaneously, until the LED turns off.



# B

## Connecting your PTT Voice Responder to Tait PTT

1. In the Tait PTT application, select 'More' displayed on the top right corner.
2. Select 'Settings'.
3. Near the bottom of the list make sure to turn on 'Allow Bluetooth Audio' and 'Bluetooth Always On'.
4. Then, select 'PTT Button' from the top of the list.
5. Then, select 'Bluetooth LE' as the connection type.
6. Finally, select your device from the Bluetooth devices menu and follow the pairing instructions that pop up on the screen.

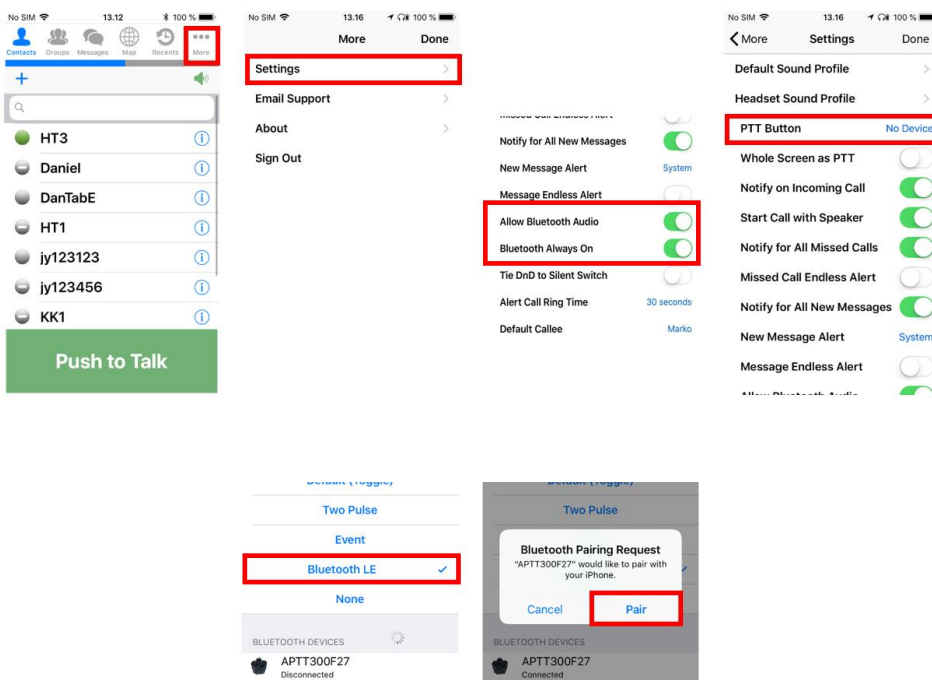

For more information on how to use the Tait PTT application please visit their website:  
[www.taitradio.com](http://www.taitradio.com)



# AINA PTT Voice Responder's main button functions when connected to Tait PTT



Button	Function
<b>Power ON/ OFF</b>	Press for more than 3 seconds to turn the device on/off.
<b>Primary</b>	Press and hold to speak. Release when you are done.
<b>Emergency</b>	Press to send an emergency alarm. This feature must be configured by your administrator for your account before it will be available and visible in the app.
<b>Arrow buttons</b>	Press the right arrow button to select the next channel (group) and the left arrow button to select the previous one.

Visit [www.aina-wireless.com](http://www.aina-wireless.com) to find additional accessories, an extended user manual of the AINA PTT Voice Responder and more user guides. If you have any further questions, you can also email us at: [sales@aina-wireless.com](mailto:sales@aina-wireless.com)

