

QUICK GUIDE

Connecting your PTT Voice Responder to TASSTA (Android) (EN)



A

Pairing your PTT Voice Responder with your smartphone via Bluetooth

1. Turn on your PTT Voice Responder by holding down the Power button for more than 3 seconds. After it is on, a blinking green light will indicate that the device is ready for pairing.
2. Turn on your smartphone's Bluetooth by going to: Settings → Bluetooth → Turn on.
3. Pair your PTT Voice Responder to your smartphone by selecting it from the 'Available devices' list. To know which device to select from the list, check the unique MAC-address on the back of your Voice Responder. Once it has successfully paired, a blue light will begin blinking on your device.

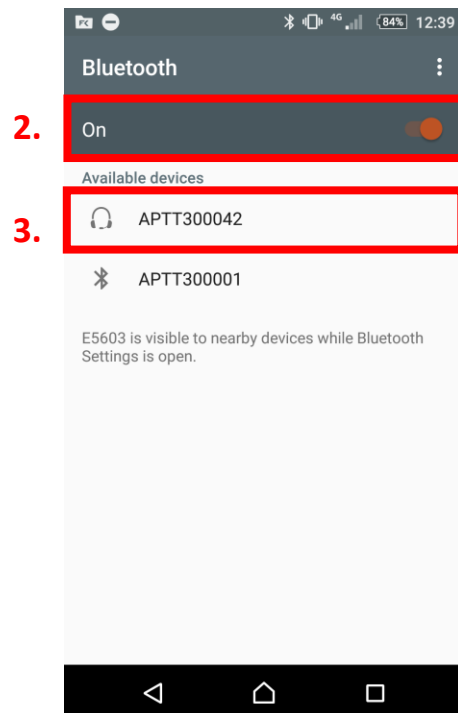

NOTE: The Voice Responder can only be paired with one device at a time. If you want to pair it to another device you need to perform an **Unpairing/ Software reset** by pressing powering the device ON and keeping the power button down for about 10 seconds.



B

Connecting your PTT Voice Responder to TASSTA

1. Select the three horizontal lines at the top left corner and select 'Settings' from the list.
2. From the Settings list, find and select 'Preferred Bluetooth Device'.
3. Select your PTT Voice Responder (according to friendly name).

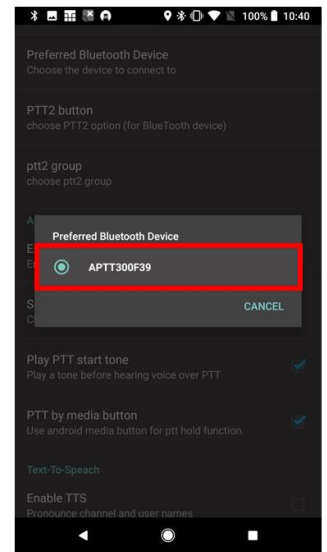
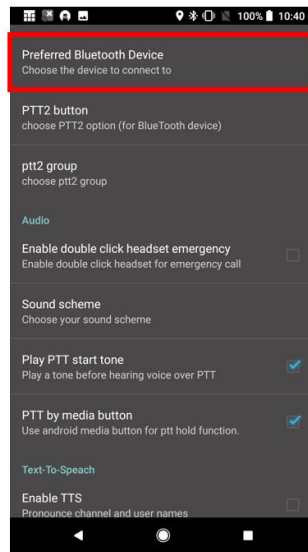
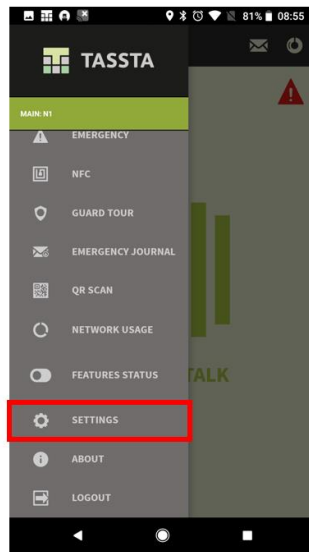

If the app cannot find your PTT Voice Responder, make sure that your Voice Responder is still connected to your phone via Bluetooth (the LED should be blinking in blue). If it is not, perform part A again.



C

Functions available

PTT1 button – Press and hold to speak to chosen contact/group. Release when you are done.

Emergency button – Press to send an emergency call.

Arrow buttons – Press either arrow button to change group.

PTT2 button - The PTT2 button can be configured to (1) respond to an individual call, (2) replay last message/history or (3) contact a second PTT group. To configure this:

1. Select the three horizontal lines at the top left corner and select 'Settings' from the list.
2. From the Settings list, find and select 'PTT2 button'.
3. Select your preferred function.

NOTE! If you want to configure your PTT2 button to contact a second PTT group you must select this from the 'PTT2 button' setting and then go to the 'ptt2 group' setting to select which group it should contact.

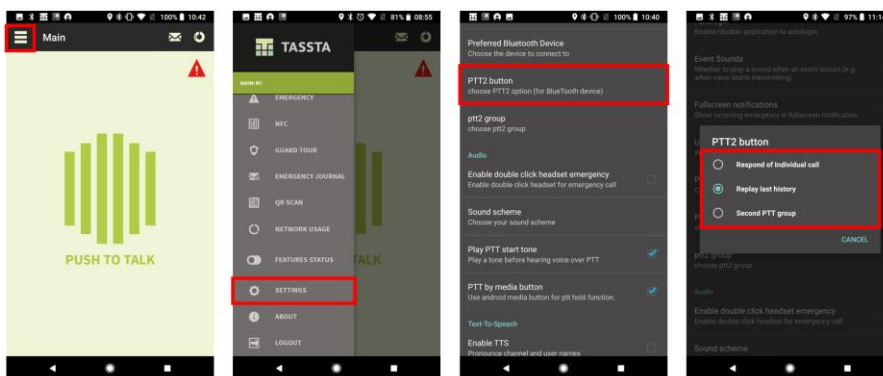

Visit www.aina-wireless.com to find additional accessories, an extended user manual of the AINA PTT Voice Responder and more user guides. If you have any further questions, you can also email us at: info@aina-wireless.com

