

# QUICK GUIDE

## Connecting your PTT Smart Button to Sonim XP5S (Android) (EN)



# A

## Pair the AINA Accessory to the Sonim XP5S

1. Press all 3 buttons on the PTT Smart Button simultaneously
2. Go to the phone's Settings and select 'Bluetooth'
3. Turn the Bluetooth function on
4. Select your PTT Smart Button from the list of available devices
5. Wait for your device to move from Available devices to Paired devices

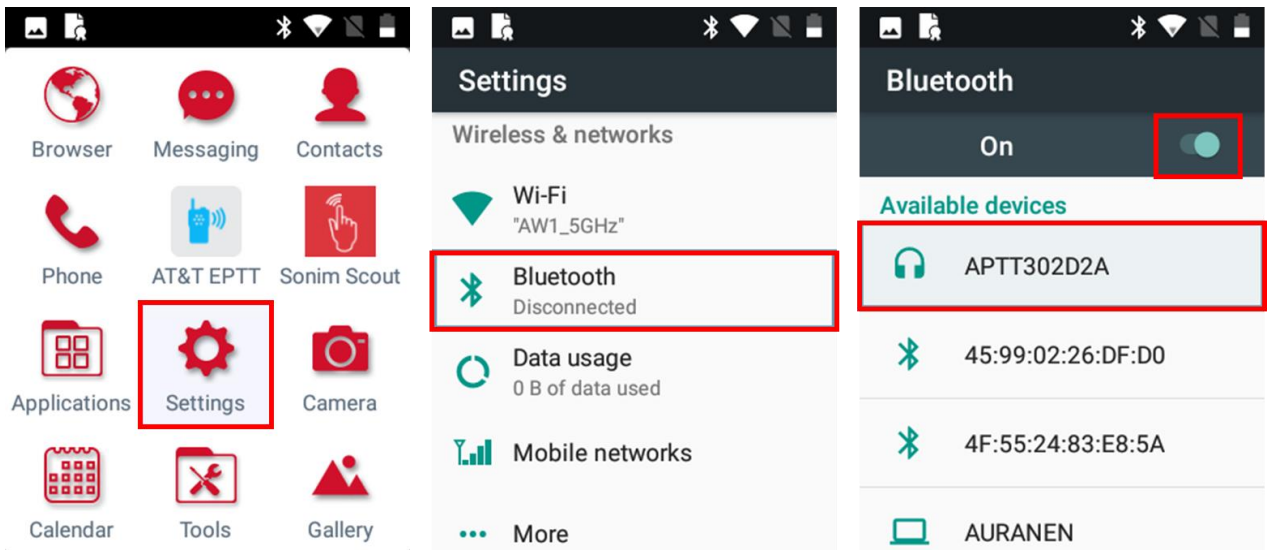

**NOTE:** The Smart Button can only be paired with one device at a time.



# B

## Connect the AINA Accessory to the Sonim BLE application

1. Search for and open the 'Sonim Scout' application from your phone
2. Select the 'Utilities' tab
3. Select 'Sonim BLE Connect'
4. Select your PTT Smart Button from the list
5. Accept the pairing request
6. Wait for the application to show that your accessory is "Connected" and its battery level

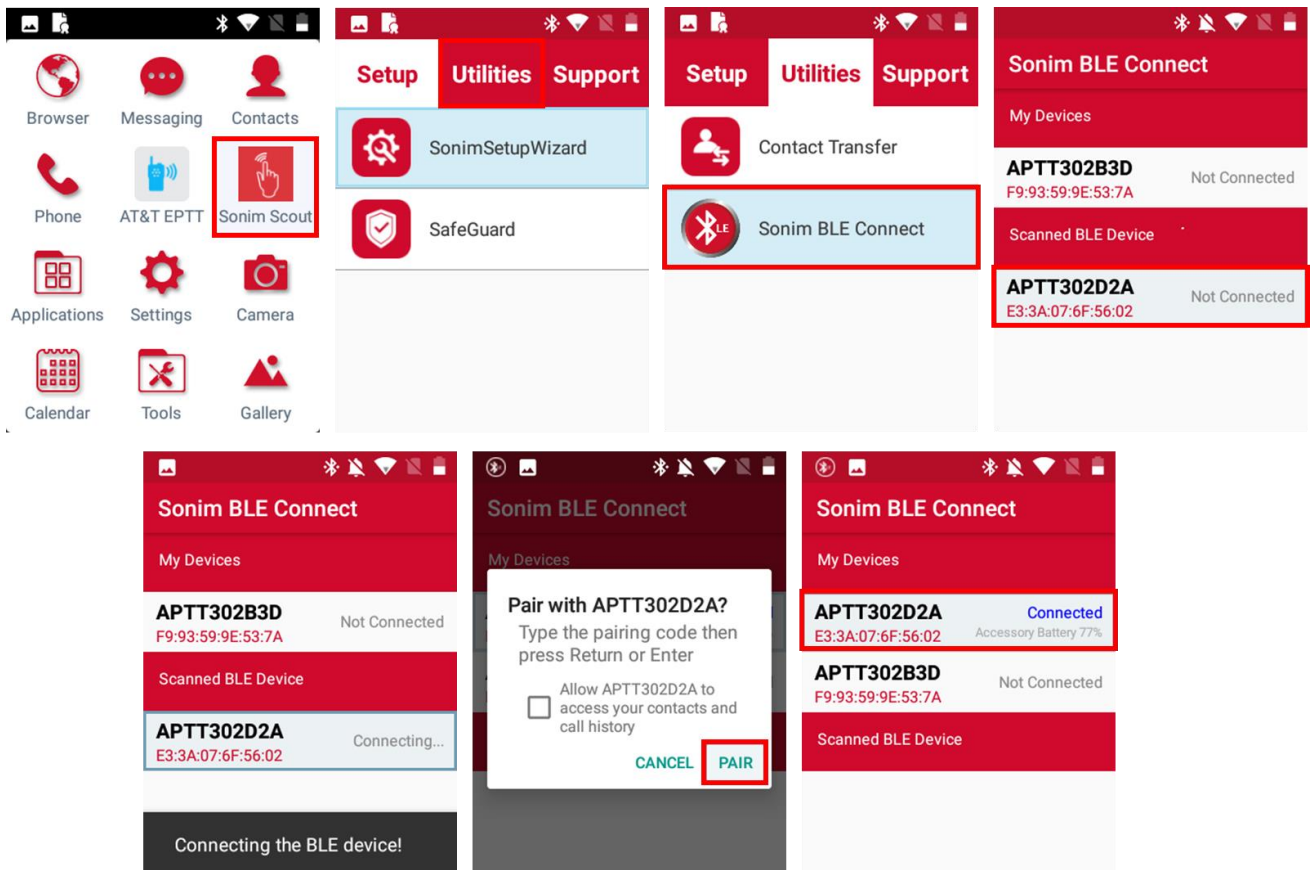

Visit [www.ainaptt.com](http://www.ainaptt.com) to find additional accessories, an extended user manual of the AINA PTT Smart Button and more user guides. If you have any further questions, you can also email us at: [sales@ainaptt.com](mailto:sales@ainaptt.com)

