

QUICK GUIDE

Connecting your PTT Smart Button
to TASSTA (iOS) (EN)



A

Pairing your PTT Smart Button to TASSTA

1. Turn on Bluetooth on your smartphone
2. Press all 3 buttons on the PTT Smart Button simultaneously
4. Select the three horizontal lines at the top left corner and select 'Settings' from the list
5. From the Settings list, turn on 'Initiate BT Connection'
6. Then, select 'Preferred BT Device'
7. Select your PTT Smart Button (according to friendly name) and accept the Bluetooth Pairing Request
8. You will see from the 'Preferred bluetooth device' menu that your device is now 'Connected'

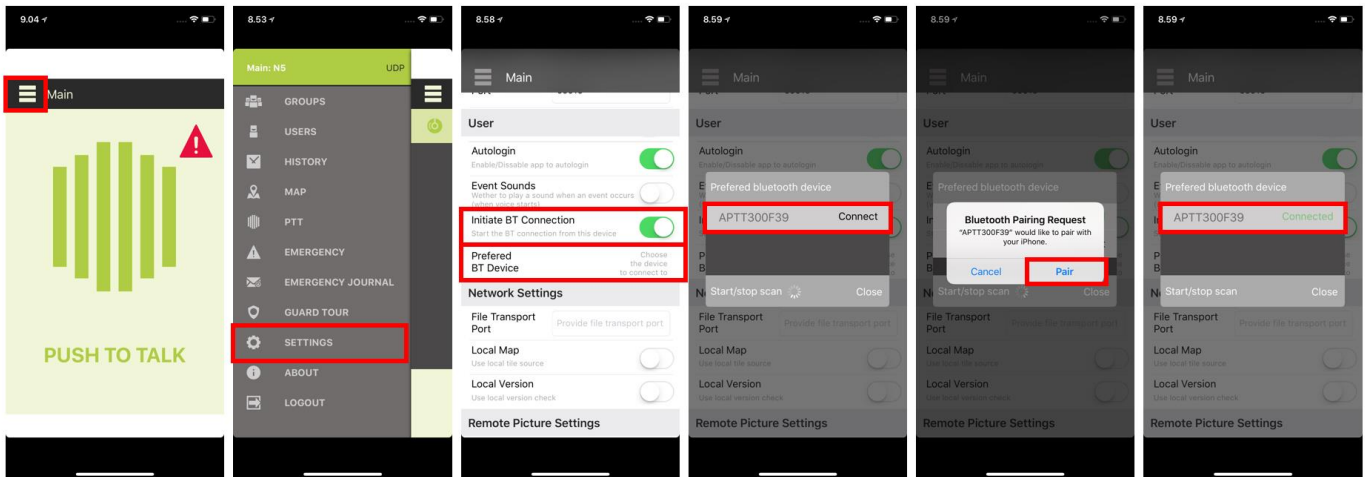

NOTE: The Smart Button can only be paired with one device at a time.



B

Functions available

PTT1 button – Press and hold to speak to chosen contact/group.
Release when you are done

Emergency button – Press to send an emergency call

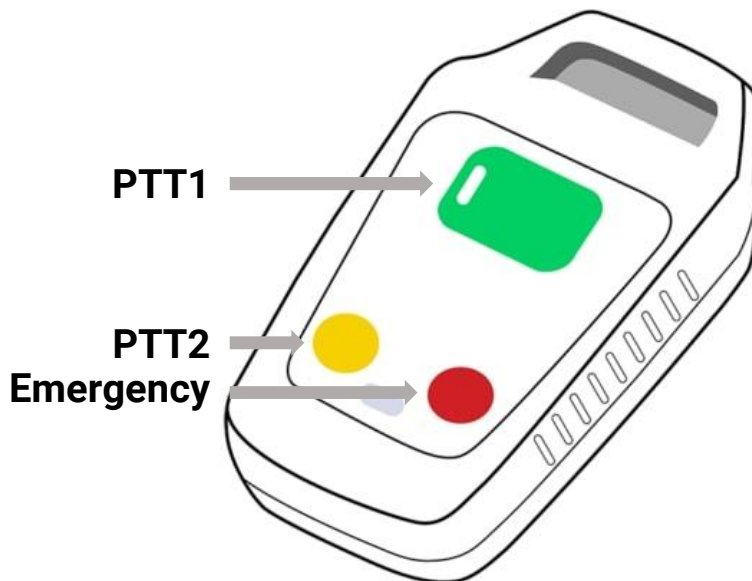

Visit www.ainaptt.com to find additional accessories, an extended user manual of the AINA PTT Smart Button and more user guides. If you have any further questions, you can also email us at: sales@ainaptt.com

