

QUICK GUIDE

Connecting your PTT Smart Button to Nova Talk (iOS) (EN)



A

Pairing your PTT Smart Button with Nova Talk

1. In the Nova Talk application, select 'More' displayed on the top right corner.
2. Select 'Settings'.
3. Near the bottom of the list make sure to turn on 'Allow Bluetooth Audio' and 'Bluetooth Always On'.
4. Then, select 'PTT Button' from the top of the list.
5. Then, select 'Bluetooth LE' as the connection type.
6. Finally, select your device from the Bluetooth devices menu and follow the pairing instructions that pop up on the screen.

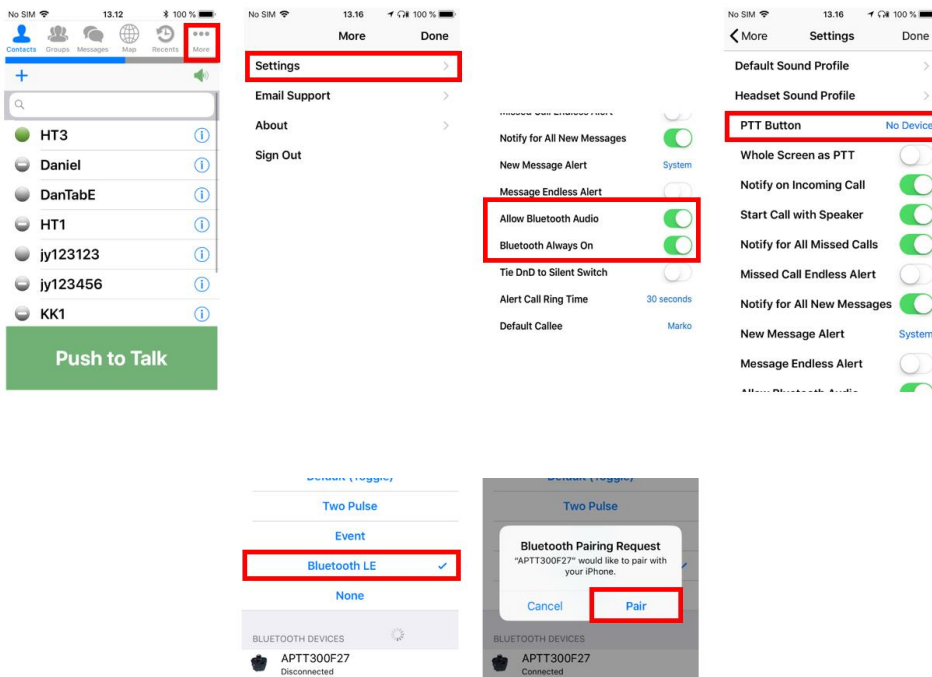

For more information on how to use the Nova Talk application please visit their website: novatekint.com/pushtotalk.html



B

Main functions available

PTT1 button – Press and hold to speak to chosen contact/group. Release when you are done.

Emergency button – Press to send an emergency alarm. This feature must be configured by your administrator for your account before it will be available and visible in the app.

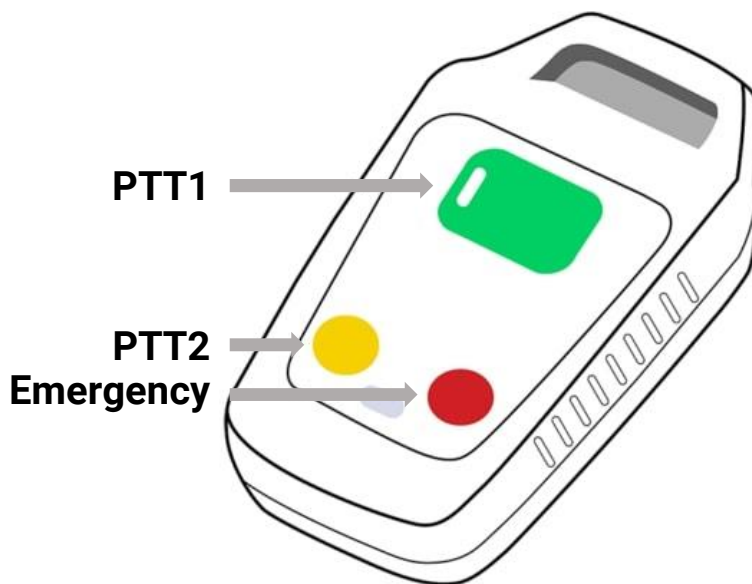

Visit www.ainaptt.com to find additional accessories, an extended user manual of the AINA PTT Smart Button and more user guides. If you have any further questions, you can also email us at: sales@ainaptt.com

